



SMV Cutting Rotor / Rechipper

Application

- Combustion (energy from waste)
- Recycling industry
- Panel board industry (PB, MDF, OSB)

Description

The SMV Cutting Rotor is an effective robust solution for the reduction of short-sized industrial waste wood, bark and fibrous raw materials into quality chips. The material is fed through the large vertical hopper, chipped by the knives of the rotor and further classified by an individually adapted refracting grid.

Customer benefits

- Wide range of input material such as screened chip oversizes, short-sized industrial waste wood, bark, annual plants, cardboard waste and fibrous raw materials
- Output material size adjustable
- Energy-efficient size reduction
- Essential parts of the machine wear-protected and exchangeable
- Low-maintenance and service-friendly

Technical features

- Large vertical infeed hopper
- Chipping rotor in heavy-duty execution with wear protection
- Counter knife of high-quality special steel, regrindable and adjustable
- Wear plate under the chipping knife, regrindable and adjustable
- Easy access to the rotor in case of maintenance



SMV Cutting Rotor/Rechipper

Type Rotor/Infeed opening mm Ø / L1 x W1	Main drive kW	Capacity ¹ t/h b.d.	Dimensions ² m (L x W x H)	Weight ² approx. t
SMV 450 / 200 x 650	22 – 55	1 – 4	0.8 x 1.0 x 1.1	1.9
SMV 600 / 300 x 650	45 – 90	2 – 6	1.1 x 1.0 x 1.4	2.6
SMV 800 / 350 x 800	55 – 132	4 – 8	1.5 x 1.2 x 1.9	4.2
SMV 1000 / 400 x 1000	90 – 200	6 – 13	1.8 x 1.4 x 2.2	6.3

1) Depending on input and size of output material

2) Dimensions and weight of basic machine without main motor and infeed hopper

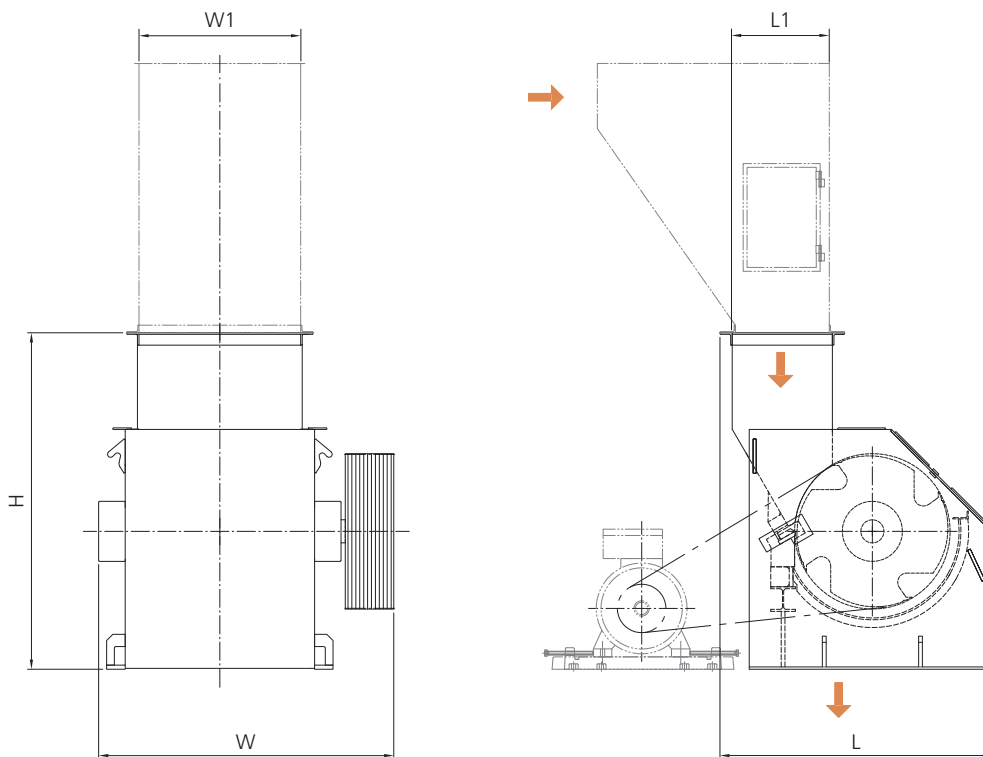

DIEFFENBACHER

MAIER